

LEGEND

- - SET 1/2" INSIDE DIAMETER IRON PIPE TAGGED L.S.8550
 - - FOUND 3/4" IRON PIPE TAGGED L.S. 3334 PER (R1)
 - ▲ - FOUND MONUMENT AS NOTED
 - ⊙ - FOUND 5/8" REBAR WITH PLASTIC CAP TAGGED L.S. 8522 PER (R2)
 - - CALCULATED POINT, NOTHING FOUND OR SET.
- (R1) - RECORD PER 49 P.M. 17
 (R2) - RECORD PER CORNER RECORD #764
 (M) - MEASURED ON THIS SURVEY
 (C) - CALCULATED DATA
- ⊕ - WELL
 Ⓞ - SEWER CLEAN OUT
 Ⓢ - SEWER MANHOLE

SPECIAL PAVING

"BOOTE AREAS"

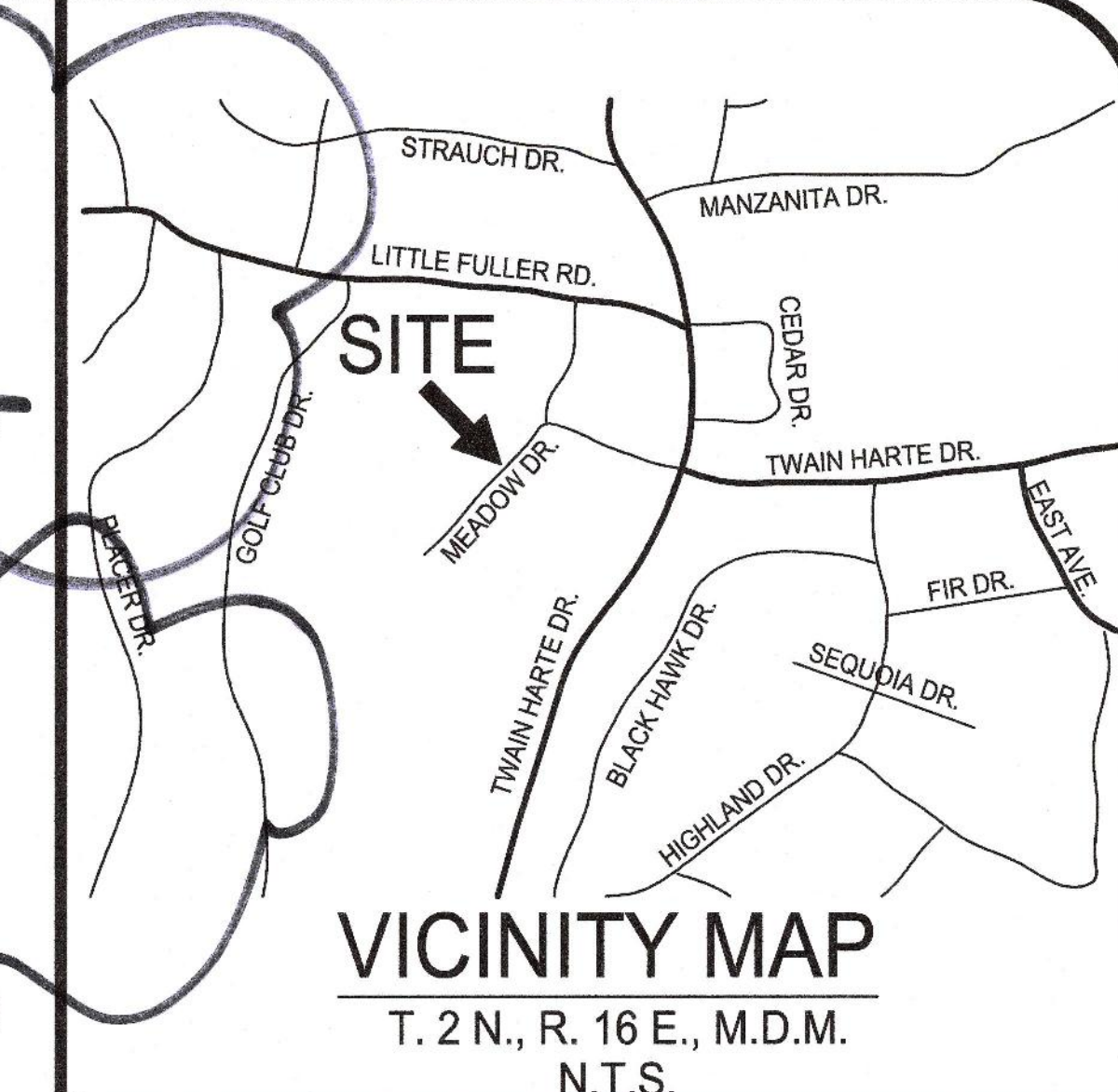

SURVEYOR'S STATEMENT

THIS MAP CORRECTLY REPRESENTS A SURVEY MADE BY ME OR UNDER MY DIRECTION IN CONFORMANCE WITH THE REQUIREMENTS OF THE PROFESSIONAL LAND SURVEYORS ACT AT THE REQUEST OF THE TWAIN HARTE COMMUNITY SERVICE DISTRICT IN JULY, 2014.

RICHARD H. JAMES DATE _____
 P.L.S. 8550

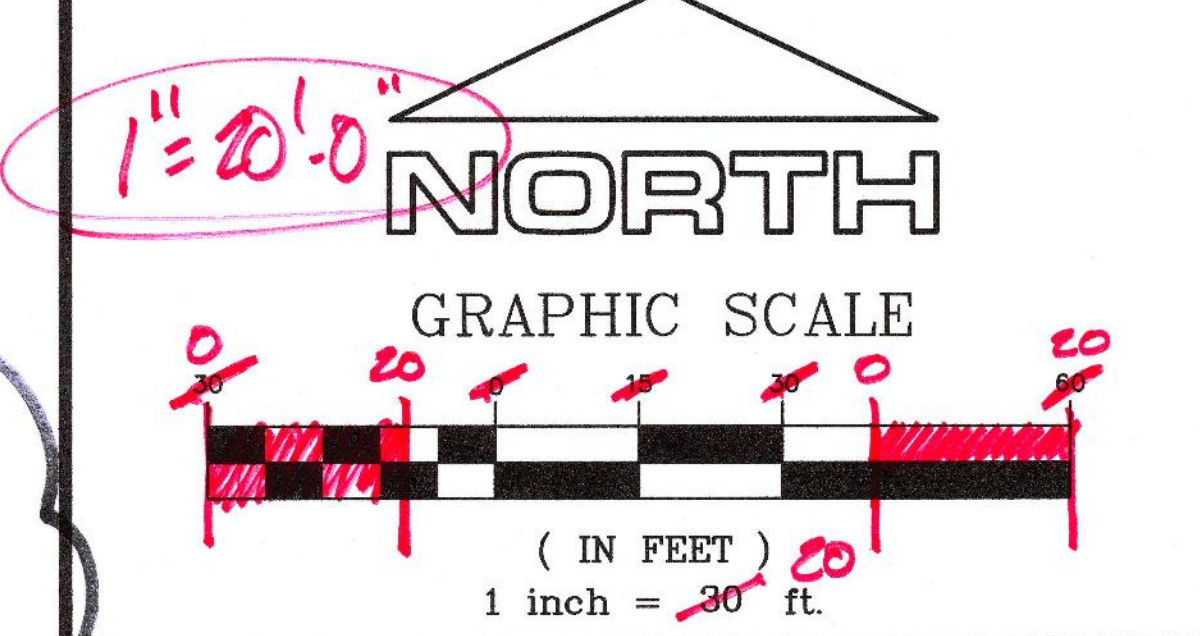

NO. _____ DRAWN BY: _____ DRAWING NAME: _____ DATE: _____
 14-04-38 RHO 7/19/15

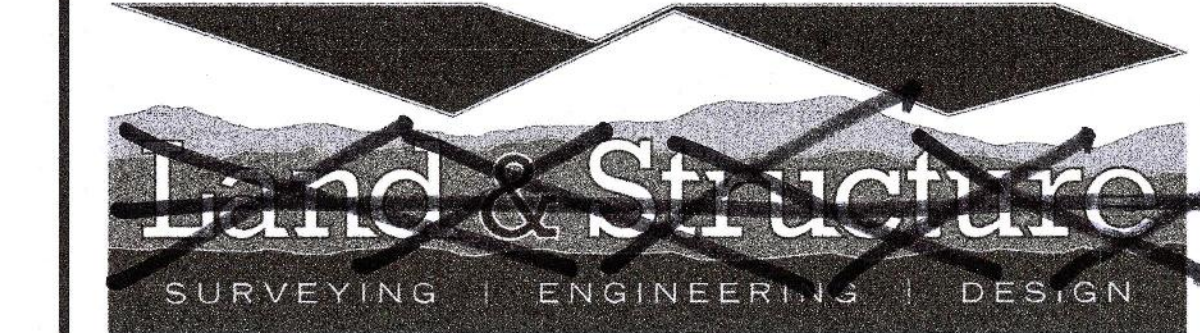

105 SOUTH STEWART STREET, SONORA, CALIFORNIA, 95370
 T: 209.532.5173 F: 209.532.5220

RECORD OF SURVEY

OF PARCEL "B" AS SHOWN IN VOLUME 49 OF PARCEL MAPS AT PAGE 17, BEING A PORTION THE SOUTHEAST 1/4 OF SECTION 8 AND THE SOUTHWEST 1/4 OF SECTION 9, TOWNSHIP 2 NORTH, RANGE 16 EAST, M.D.M., TUOLUMNE COUNTY, CALIFORNIA

MEADOW DRIVE

PARCEL "A"
 49 P.M. 17

"SEASONAL TREE"

"LAWN AREAS (TYPICAL)"

T.H.C.S.D. LOT "A"

PARCEL "B"
 20 P.M. 78

PARCEL "B"
 20 P.M. 78

PARCEL "C"
 49 P.M. 17

"FOCAL GAZEBO"

PARCEL "D"
 49 P.M. 17

NOTES

- 1) - ALL BEARINGS AND DISTANCES SHOWN ARE RECORD UNLESS OTHERWISE NOTED
- 2) - THE PURPOSE OF THIS MAP IS TO FACILITATE THE FUTURE CONVEANCE OF THE PORTION OF PARCEL "B" PER VOLUME 49 OF PARCEL MAPS AT PAGE 17 SHOWN AS T.H.C.S.D. LOT "A" ON THIS MAP PURSUANT TO SECTION 66428(a)(2) OF THE SUBDIVISION MAP ACT

COUNTY SURVEYOR'S STATEMENT

THIS MAP HAS BEEN EXAMINED IN ACCORDANCE WITH SECTION 8762 OF THE PROFESSIONAL LAND SURVEYORS ACT THIS _____ DAY OF _____, 20____.

MARILYN FITZSIMMONS, P.L.S. 6940 DATE _____
 COUNTY SURVEYOR

"LAWN OUTLYING PERIMETER PICNIC/BBQ AREAS (TYPICAL)"

BASIS OF BEARINGS

CALIFORNIA LAMBERT GRID ZONE III BETWEEN FOUND MONUMENTS SHOWN HEREON

RECORDER'S STATEMENT

FILED THIS _____ DAY OF _____, 20____ AT _____ M. IN BOOK _____ OF RECORD OF SURVEYS, AT PAGE _____, AT THE REQUEST OF THE COUNTY SURVEYOR.

FEE : _____

KEN CAETANO DEPUTY COUNTY RECORDER

** FOR LANDSCAPE CONCEPTUAL ONLY M.GILMORE*

